

AA Alternative Air
STORE FIXTURES

Tel: (609) 261-5870

Fax: (609) 261-5531



Curved Front Candy Merchandiser

WWW.AAFIXTURES.COM

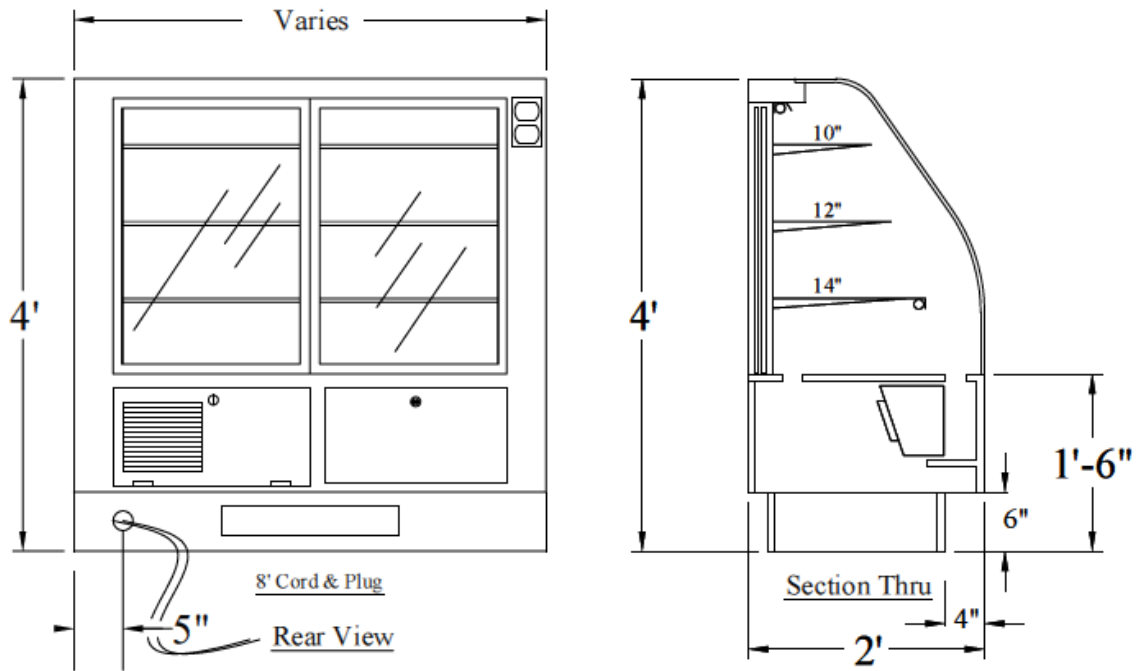

REFRIGERATED CANDY MERCHANDISERS

MODEL #	L x D x H	COMPRESSOR	AMPS / 115V	LBS
AACCD-36-R	36" x 24" x 48"	1/5 hp	7.1	400
AACCD-48-R	48" x 24" x 48"	1/5 hp	7.1	475
AACCD-60-R	60" x 24" x 48"	1/5 hp	7.1	550
AACCD-72-R	72" x 24" x 48"	1/5 hp	7.1	650
AACCD-96-R	96" x 24" x 48"	1/5 hp	7.1	750

DRY CANDY MERCHANDISERS

MODEL #	L x D x H	COMPRESSOR	AMPS / 115V	LBS
AACCD-36-D	36" x 24" x 48"	N/A	1.6	325
AACCD-48-D	48" x 24" x 48"	N/A	1.9	400
AACCD-60-D	60" x 24" x 48"	N/A	4.7	500
AACCD-72-D	72" x 24" x 48"	N/A	5.3	600
AACCD-96-D	96" x 24" x 48"	N/A	5.7	650

A.A. Store Fixtures

ETL LISTED

COMMERCIAL REFRIGERATORS

& FREEZERS

9902041

CONFORMS TO ANSI/UL STD 471 & NSF-7 APPROVED

Note: Refrigerated Candy Displays with humidity control are designed to maintain temperatures between 60°F and 65°F.